

DOMINION
VOTING™



Our customers come first.

DEMOCRACY SUITE IMAGECAST EVOLUTION QUICK REFERENCE GUIDE

8/4/2020

[PAGE INTENTIONALLY LEFT BLANK]



Ice Machine Seals for Canvass/Seal Recording Sheet

(Nov. 3rd General Election)



1. BALLOT BOX DOOR SEAL



2. LARGE TOP COVER (1 SEAL ON EITHER END)



3. SCANNER LOCK **FRONT RIGHT SEAL**



4. SCANNER LOCK **BACK LEFT SEAL**



Ice Machine Seals for Canvass/Seal Recording Sheet

(Nov. 3rd General Election)

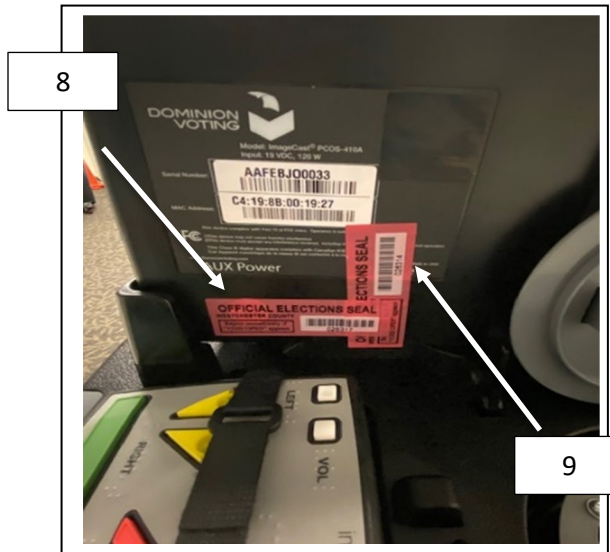
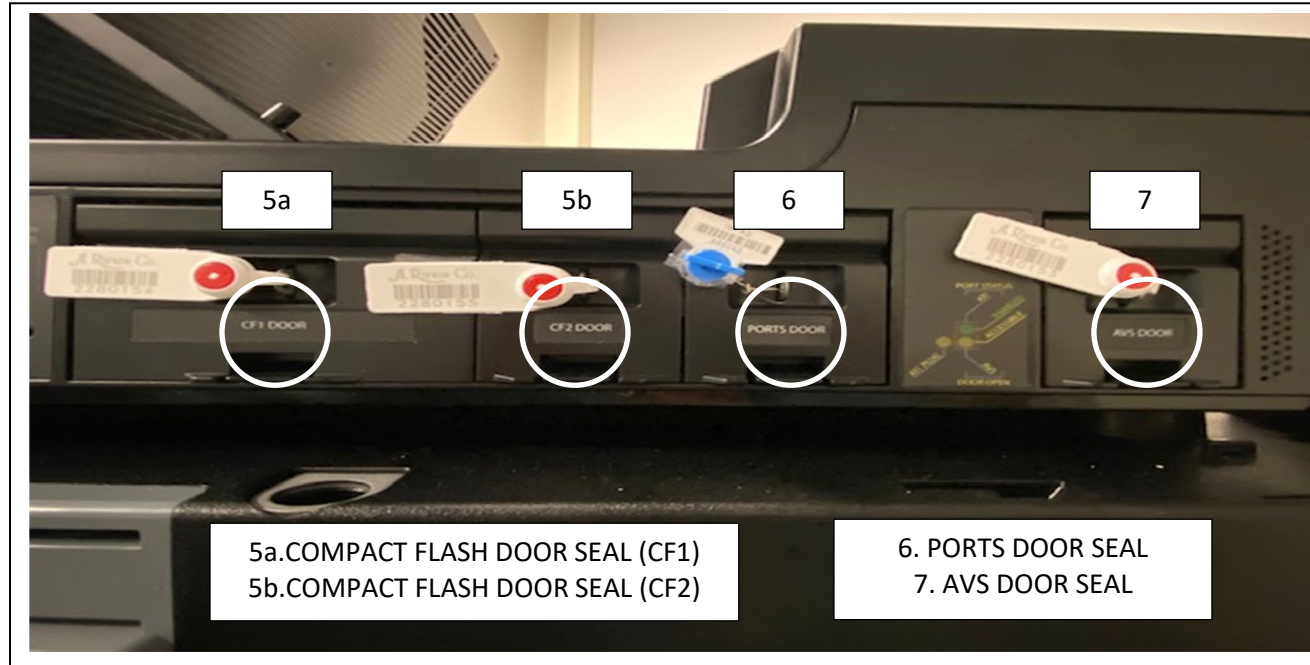

8. AUX POWER SEAL
9. LIGHT POLE SEAL

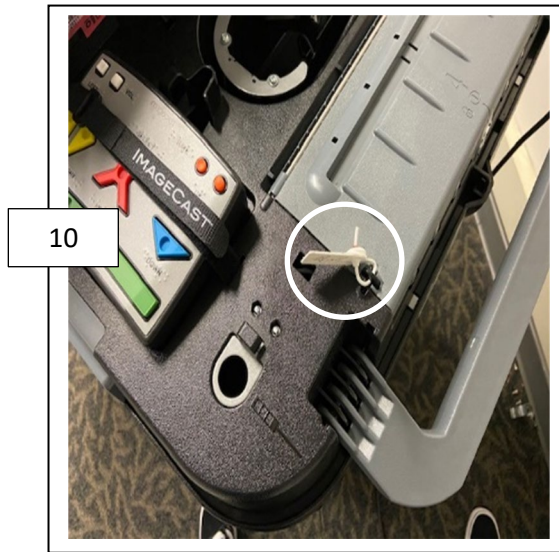

10.EMERGENCY BALLOT BOX
DOOR SEAL

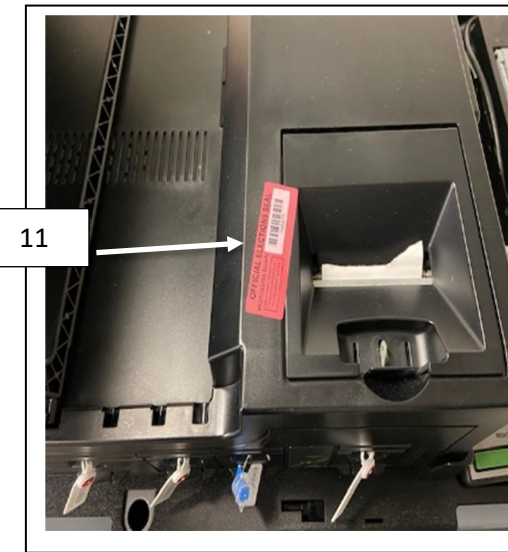

11.THERMAL TAPE
RECEIPT DOOR SEAL

Starting Up The ImageCast Evolution (ICE)

Before turning the unit on, unlock and/or lift up the Audio Tactile Interface (ATI) door to expose the ATI port. Connect the ATI to it.

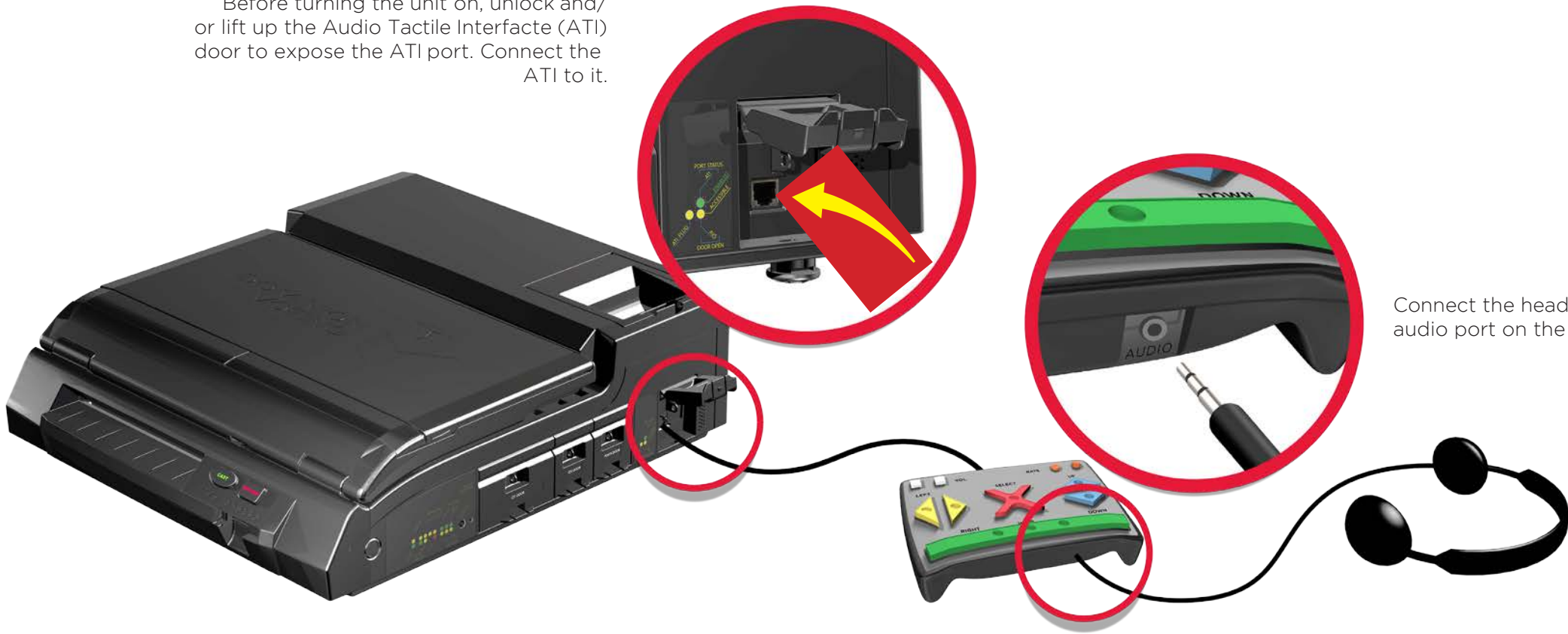

Connect the headphones to the audio port on the ATI.

Starting Up The ImageCast Evolution (ICE)



1 Turn the unit on by lifting the screen to its operating position.



2 Lower the monitor support stand and fix it into the desired position.

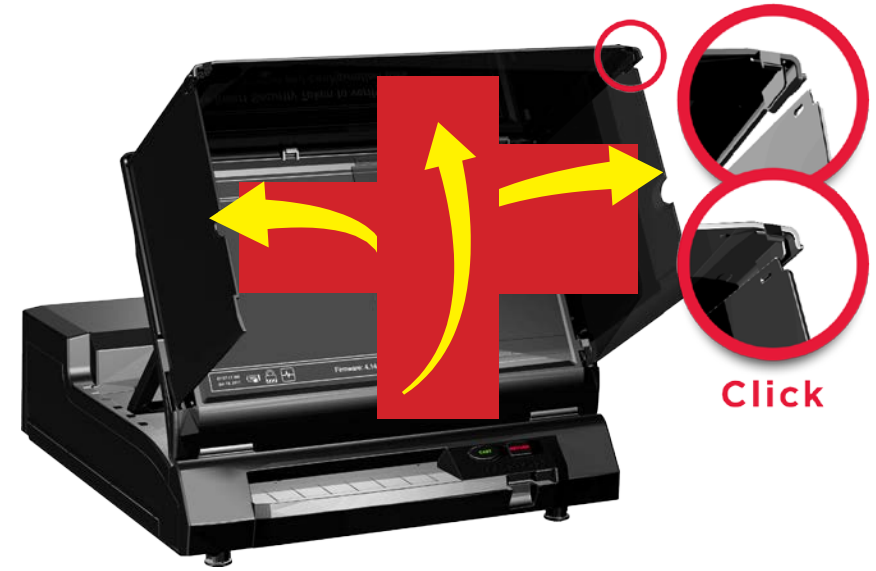

3 Lift the monitor cover up. Open the left and right flaps to reveal the screen. Secure the top cover over the left and right flaps.



The unit will make a beeping sound and ask you to



4 Press and hold the Security Token onto the receptacle on the right side of the unit to prompt the login screen.

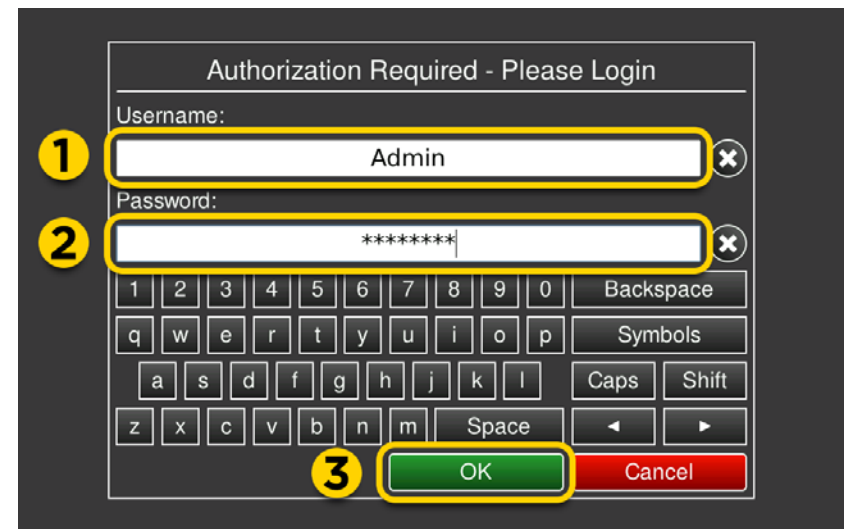

5 Fill in the **Username** (1) and **Password** (2) fields. When complete, press the **OK** button (3).

Opening The Poll

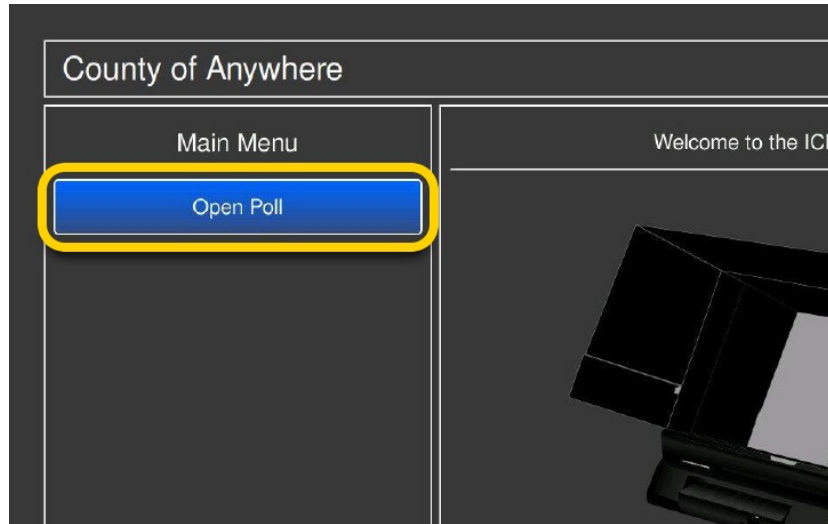

1 Press **Open Poll**.

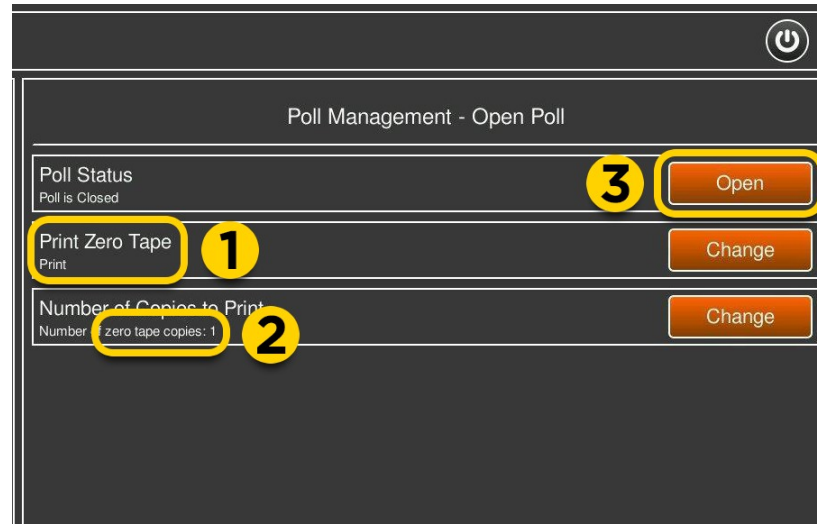

2 You can change the **Print Zero Tape** options (1 and 2) by pressing **Change** on the right. Once set, press **Open** (3).



3 The **Open Poll Confirmation** screen appears. Press **OK** to continue or **Cancel** to return to the previous screen.



4 If the **Print Zero Tape** option was set to **Print**, the zero tape will begin printing.

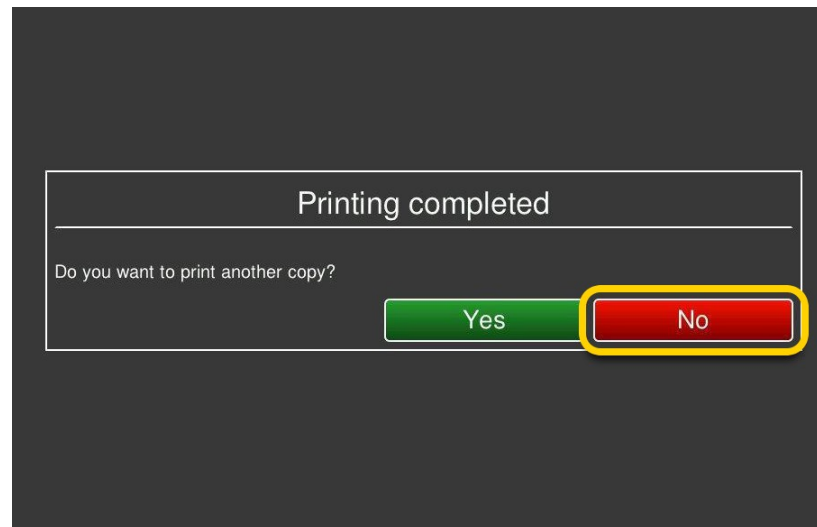

5 The **Printing completed** screen appears. Press **Yes** to print additional copies of the zero tape. Press **No** to continue.

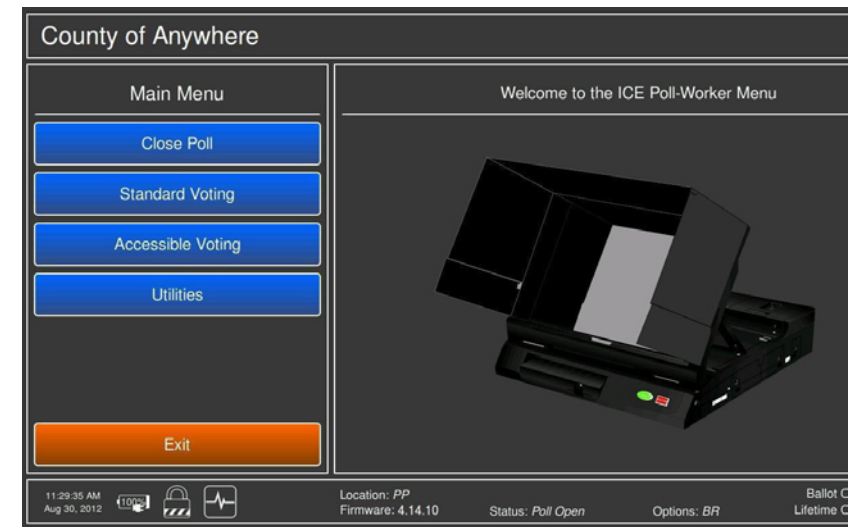

6 The poll is now open. The **Main Menu** screen appears.

Starting Standard Voting Sessions

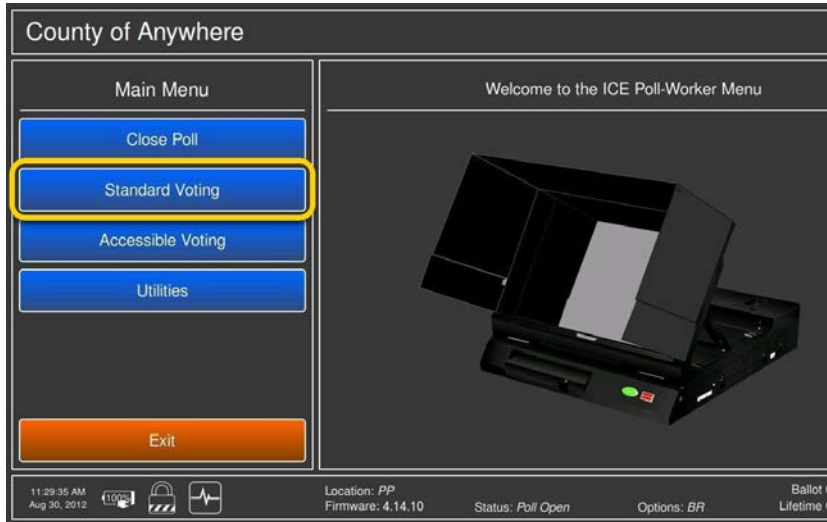

1 Standard Voting session is for scanning marked paper ballots. To commence a Standard Voting session, Press **Standard Voting** on the **Main Menu**.

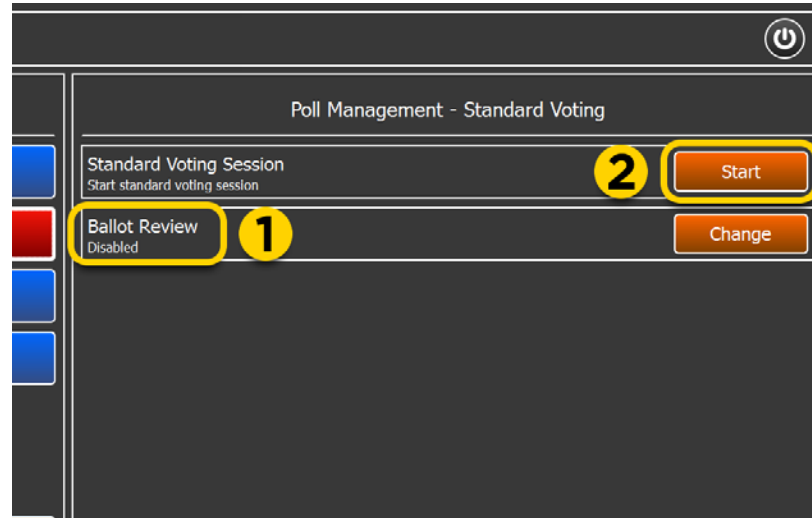

2 If Ballot Review is set to **Enabled** or **Enabled Once**, press **Change** until it says **Disabled** (1). Then press **Start** (2).

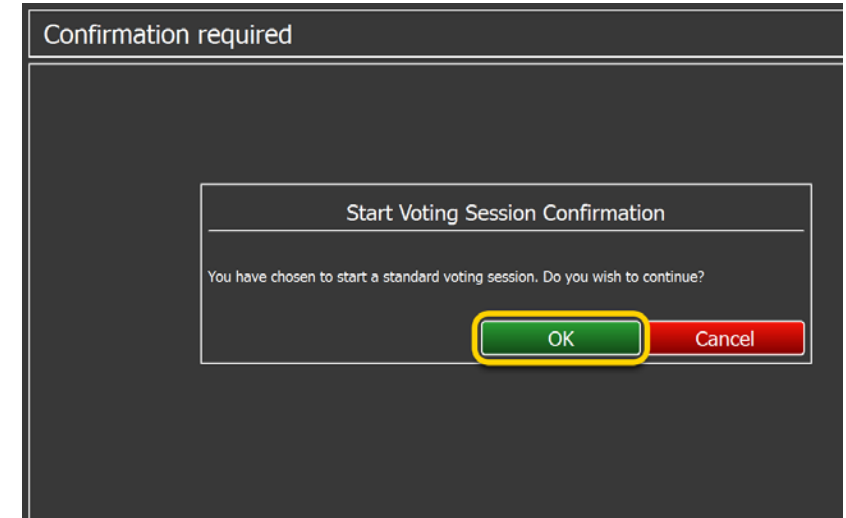

3 The **Start Voting Session Confirmation** screen appears. Press **OK** to continue or **Cancel** to return to the previous screen.

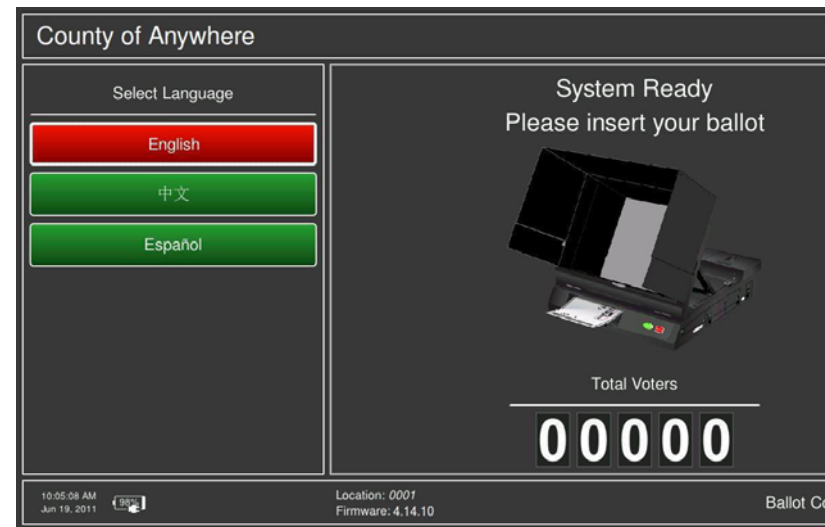

4 Voters can now begin to scan ballots.



1 Valid Ballot and Casting Ballot Please Wait

Once the ballot is cast successfully, the **System Ready** screen reappears and the **Ballot Counter** increases by one (1).

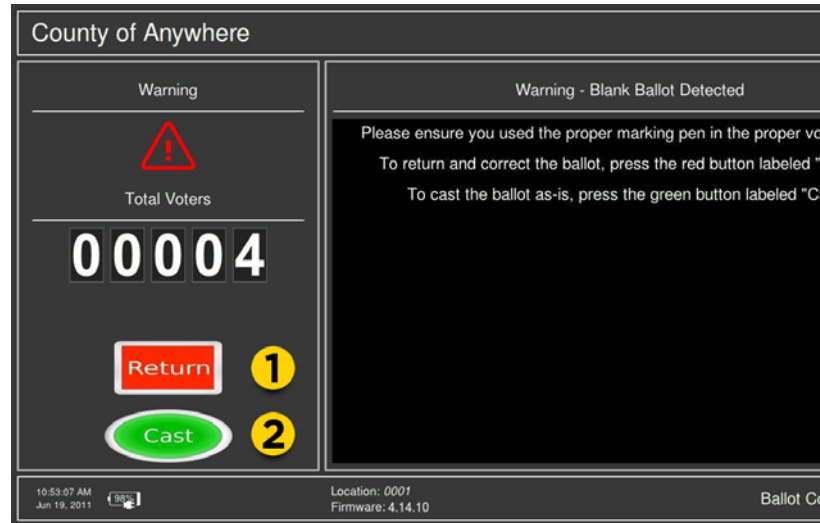

2 If a blank ballot, or overvoted ballot is scanned, the tabulator displays instructions on how to proceed. You can choose to return your ballot to correct it or cast the ballot as is. To return the ballot, press **Return** (1). To cast the ballot as is, press **Cast** (2).

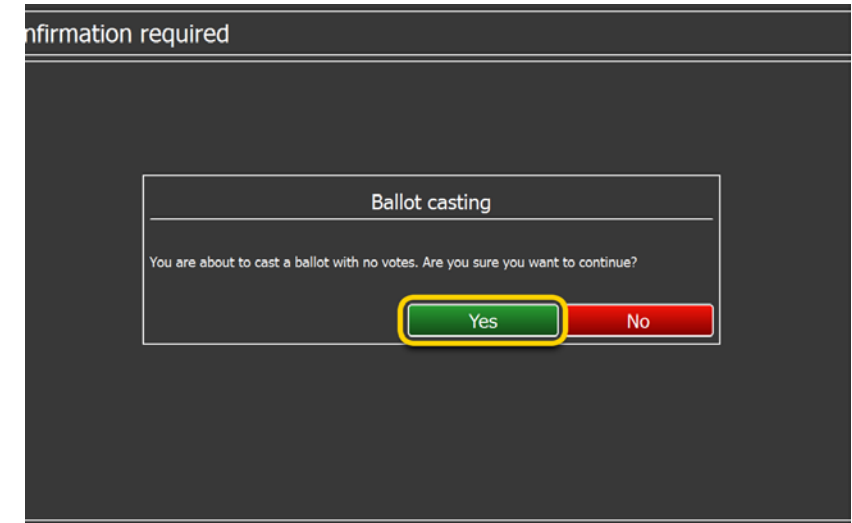

3 If you pressed **Return**: The ballot is returned via the tabulator's entry slot. Correct your ballot and retry. If you pressed **Cast**: The **Ballot casting** confirmation screen appears. Press Yes to continue casting your ballot

Tabulator Warning Messages

Blank Ballot Warning	The tabulator does not detect any voter selections on the scanned ballot. Please ensure you used the correct marking pen.
Cross Party Endorsement	You have selected the same candidate on multiple party lines. If you choose to cast the ballot as is, your selections will be counted as 1 vote for the candidate.
Overvote Warning	Change with: One or more contests have too many votes. If you choose to cast the ballot as is, votes in overvoted contests will not be counted.
Ambiguous Marks	The tabulator detected marks on the ballot but the selections are unclear. The ballot will be returned automatically.

Starting Provisional Voting Sessions for Accessible Voting

Provisional Voting Function: The Provisional ballot will NOT be counted or cast. However this function can be used for the voter to see how the machine will read their ballot. Provisional votes must be reviewed by the Board of Elections. Follow proper procedures for returning Provisional Ballots to the Board of Elections.

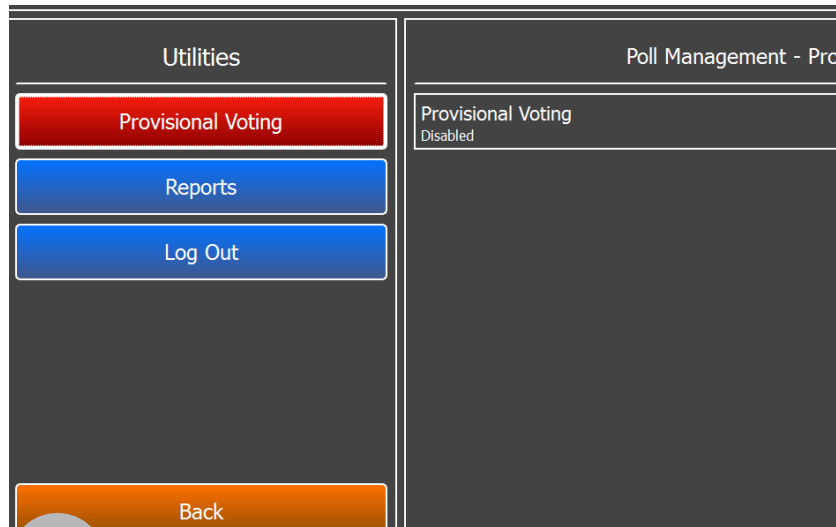

1 If a Provisional Voting Session is required, press **Utilities** on the **Main Menu** and select **Provisional Voting**.

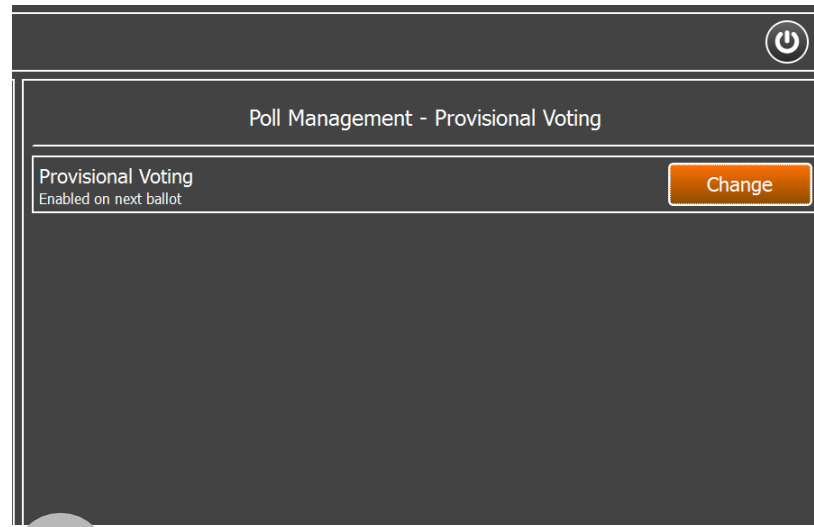

2 On the **Poll Management - Provisional Voting** screen, press **Change** to set Provisional Voting to **Enabled on next ballot**. Press **Back** to return to the **Main Menu**.

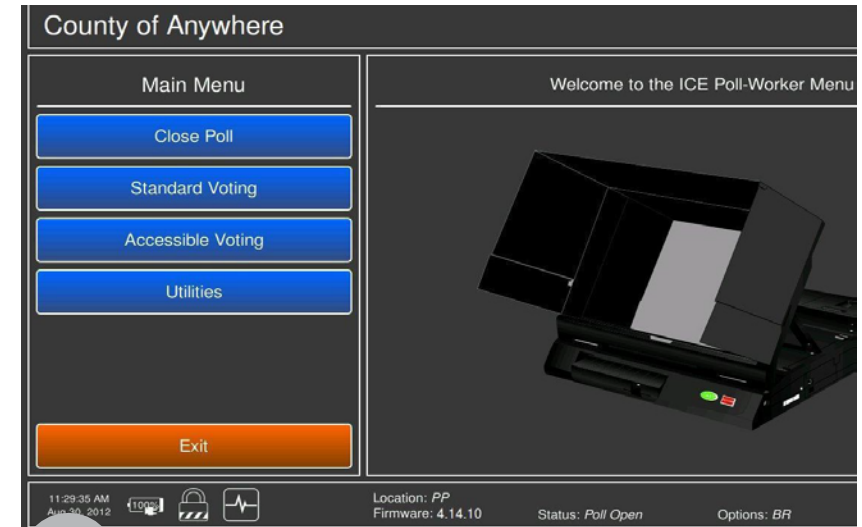

3 Press **Accessible Voting** on the **Main Menu** and proceed with an Accessible Voting Session as described in the steps on page 10.

Audio Tactile Interface (ATI) Overview

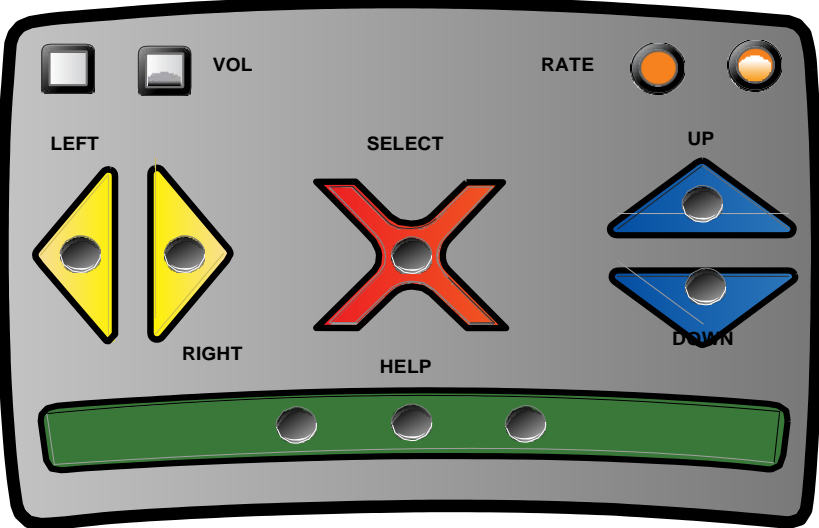

Voters who choose to vote with the assistance of an Accessible Voting Session can use an Audio Tactile Interface (ATI).

The ATI is a handheld controller that contains 10 navigational and configuration buttons.

Buttons are described by their shape and color both audibly and on-screen. The buttons are also labeled in Braille.

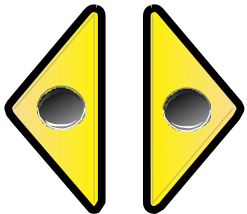

Use the yellow left and right arrows to navigate between contests.

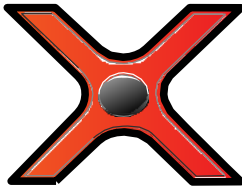

Use the red X-shaped button to make a selection.

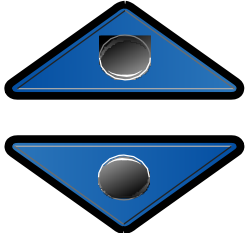

Use the blue up and down arrows to navigate to the next (down) or previous (up) instruction or candidate.



Use the volume up and down buttons to turn the volume



Use the orange rate buttons to speed up or slow down the audio.



Use the green help bar to pause the voting session or request assistance.

Starting Accessible Voting Sessions

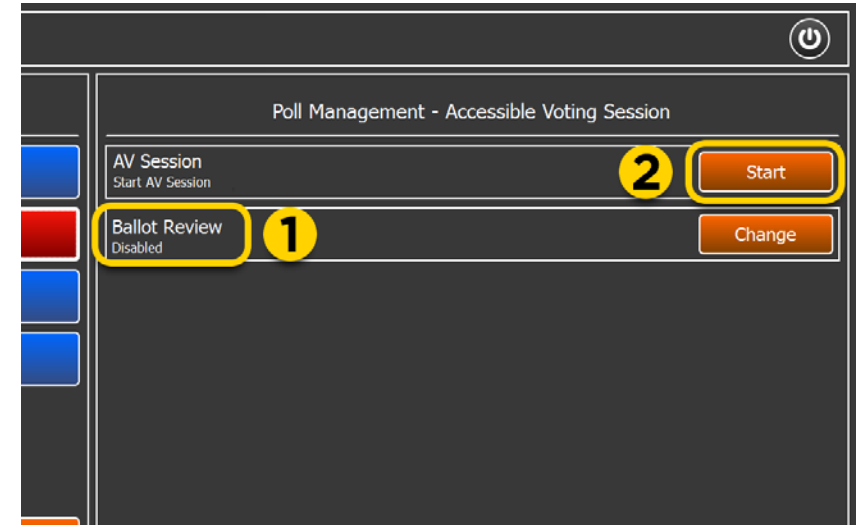
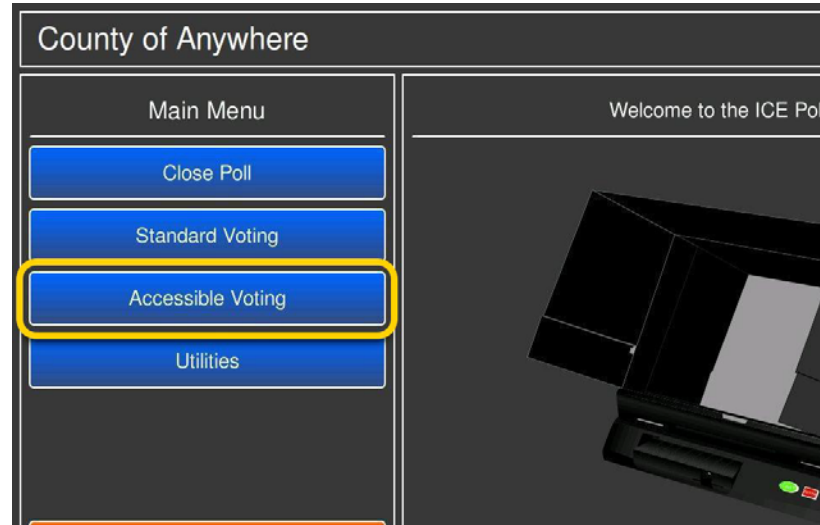

1 Press and hold the Security Token onto the receptacle on the right side of the unit to prompt the login screen.

2 To commence an Accessible Voting session, press **Accessible Voting** on the **Main Menu**.

3 Make sure ballot review is set to **Disabled** (1). Accessible voters will have a chance to review their choices before their ballot is marked and cast. Press **Start** (2).

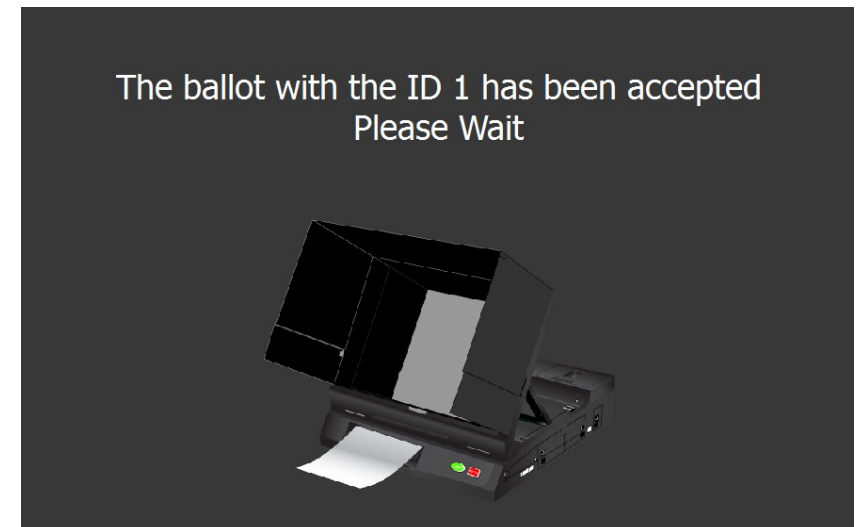
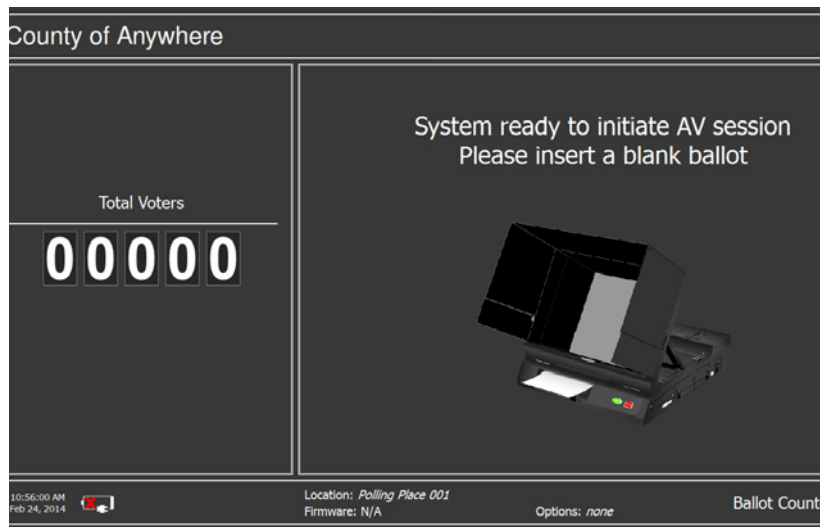
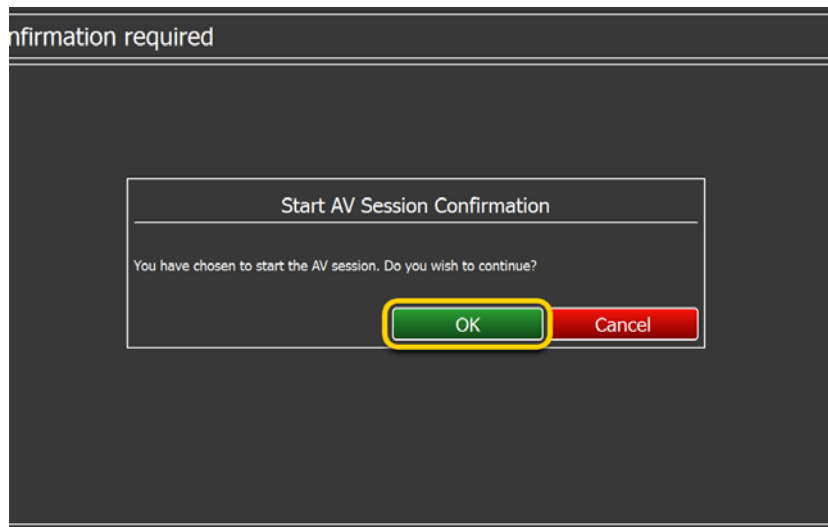

4 The **Start AV Session Confirmation** screen appears. Press **OK** to continue or **Cancel** to return to the **Main Menu**.

5 Insert, or have the voter insert, a blank ballot to begin the Accessible Voting Session.

6 A message indicating the ballot has been accepted appears.

Starting Accessible Voting Sessions

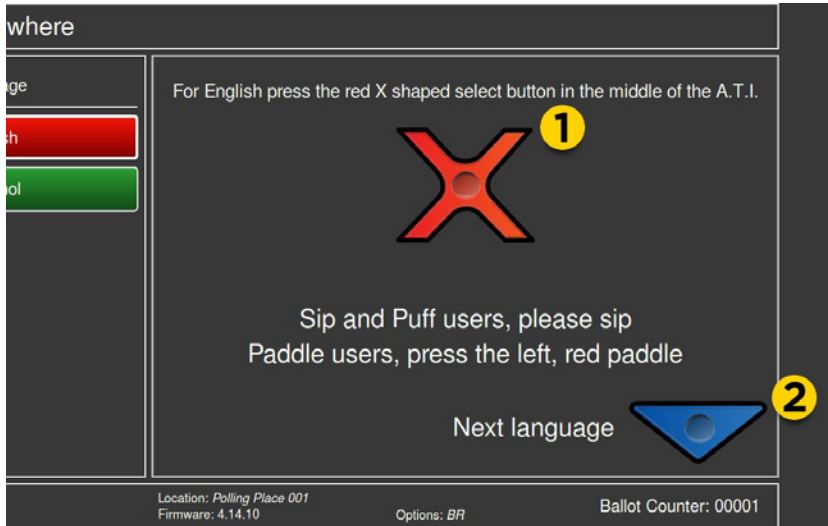

7 To select the first language that appears on the screen (e.g. English), on the ATI, press the red X-shaped select button (1). For the next language on the list, press the blue down arrow (2).

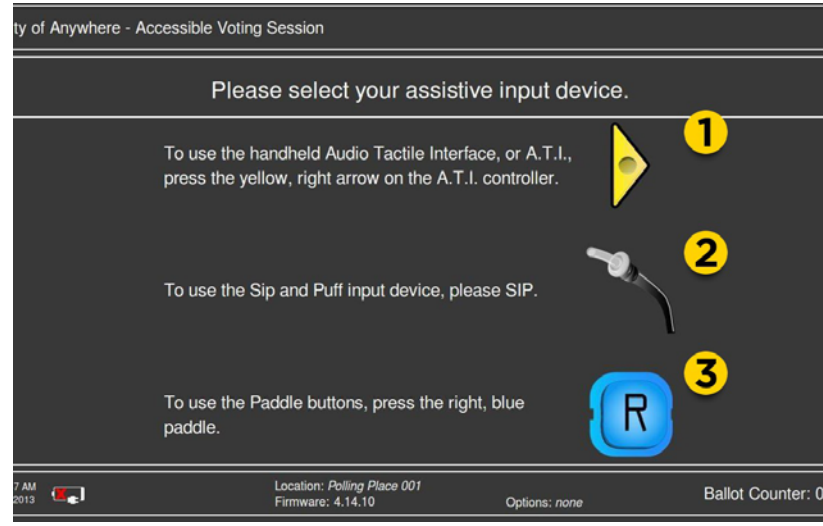

8 To use the ATI, press the yellow, right arrow (1). To use the sip and puff input device, please sip (2). To use the paddle buttons, press the blue right paddle (3).

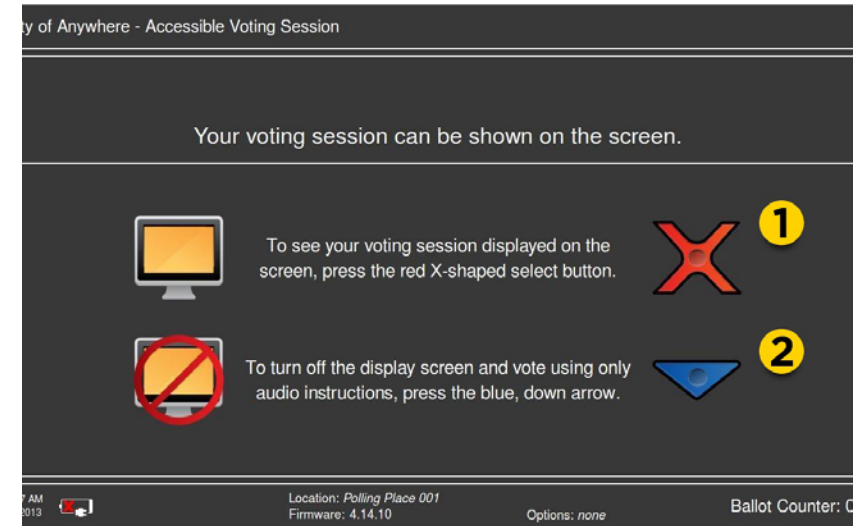

9 To see your voting session on the screen, press the red X-shaped select button (1). To turn off the screen and vote with audio instructions, press the blue down arrow (2).

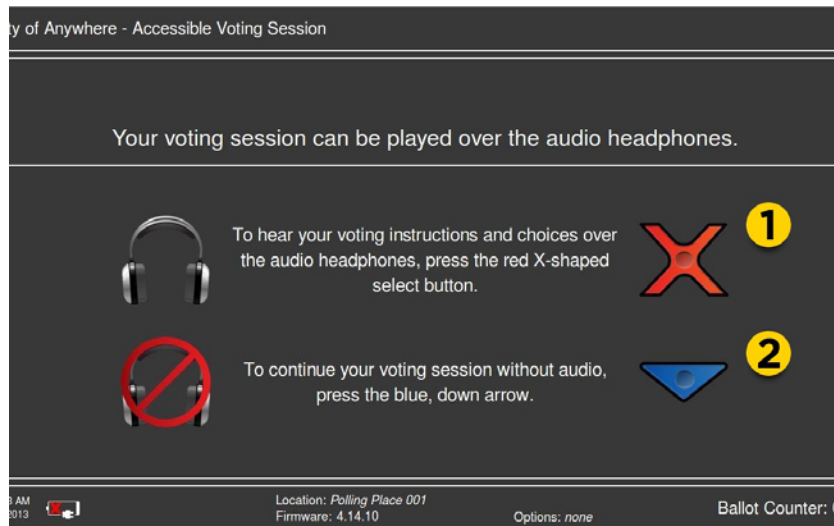

10 To play your voting session over audio headphones, press the red X-shaped select button (1). To continue voting session without audio, press the blue down arrow (2).

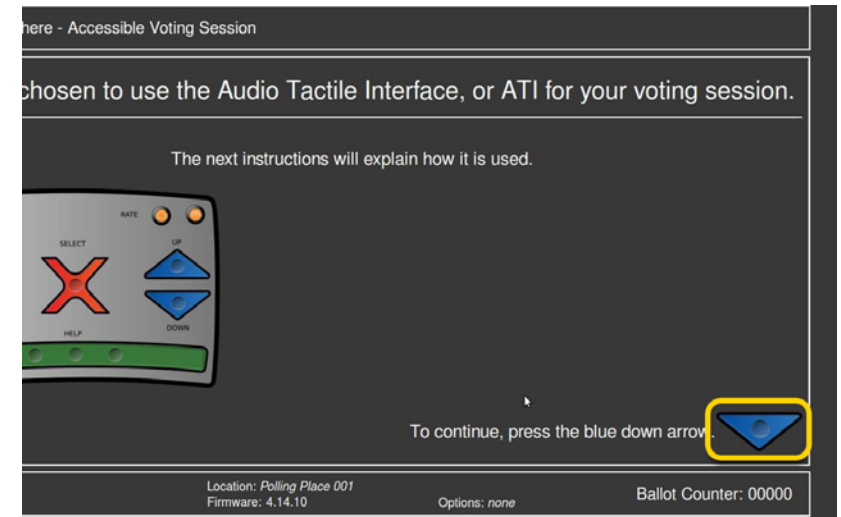
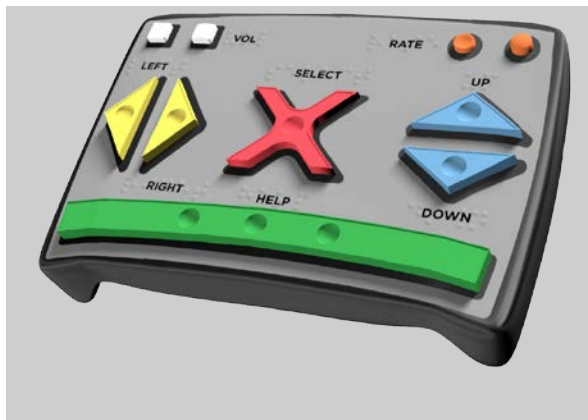

11 A welcome screen is presented to the voter with accompanied audio instructions. Press the blue down arrow to continue the Accessible Voting session.

Starting Accessible Voting Sessions

g Session

audio volume, use the two square, white, 

audio speed, use the two round, orange, 

ns.

en contests, use the yellow left and right 

est and move between contest choices, 

and down pointing arrows.

elect a choice, use the large red, X- 

utton.

ession or to ask for help, use the long 

n at the bottom of the ATI.

To continue, press the blue, down 

arrow

Location: Polling Place 001
Firmware: 4.14.10 Options: none Ballot Counter: 00000

12 Navigational instructions are presented. The voter can increase or decrease audio volume by pressing the white buttons on the ATI. The round orange buttons change the audio's speed. To move between contests, use the yellow left and right arrows. To enter a contest and move between candidates, use the blue up and down arrows. To select, or deselect a candidate, use the red X-shaped select button. To call for assistance or help, press the green spacebar in the middle of the ATI.

where - Accessible Voting Session

Ballot Zoom Level

You can change the ballot zoom level. To do that, press the red X-shaped select button.

1 

To accept the current zoom level and continue, press the blue down arrow.

2 

Location: Polling Place 001
Firmware: 4.14.10 Options: none Ballot Counter: 00000

13 To change the ballot zoom, press X shaped select button (1). To accept the current zoom level and proceed, press the blue, down arrow (2).

where - Accessible Voting Session

Ballot Contrast

You can change the display contrast of the ballot. To change the contrast, press the red X-shaped select button.

1 

To accept the current contrast and continue, press the blue, down arrow.

2 

Location: Polling Place 001
Firmware: 4.14.10 Options: none Ballot Counter: 00000

14 To change the ballot contrast, press X shaped select button (1). To accept the current contrast, and proceed, press the blue, down arrow (2). If you press blue, up arrow, you will go back to previous screen.

where - Accessible Voting Session

You are now ready to begin voting

1 

To begin voting, press the blue, down arrow.

2 

Location: Polling Place 001
Firmware: 4.14.10 Options: none Ballot Counter: 00000

15 To begin the Accessible Voting session, press the blue down arrow (2). To return to the previous screen, press the blue up arrow (1).

of Florida Inclusive - Accessible Voting Session

Ballot

Location: Polling Place 001
Firmware: N/A Options: none Ballot Counter: 00000

16 The ballot is presented on the screen. The voter will make their selections.

Closing The Poll



1 Press and hold the Security Token onto the receptacle on the right side of the unit to prompt the login screen.

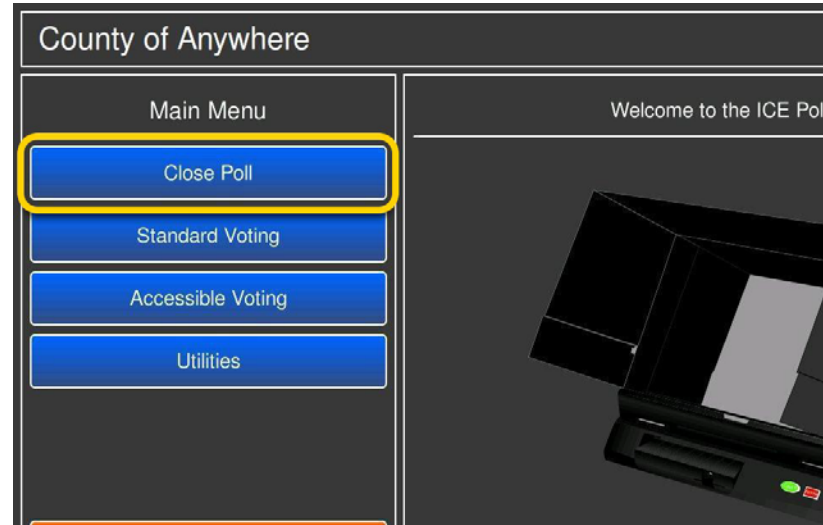

2 Press **Close Poll**.

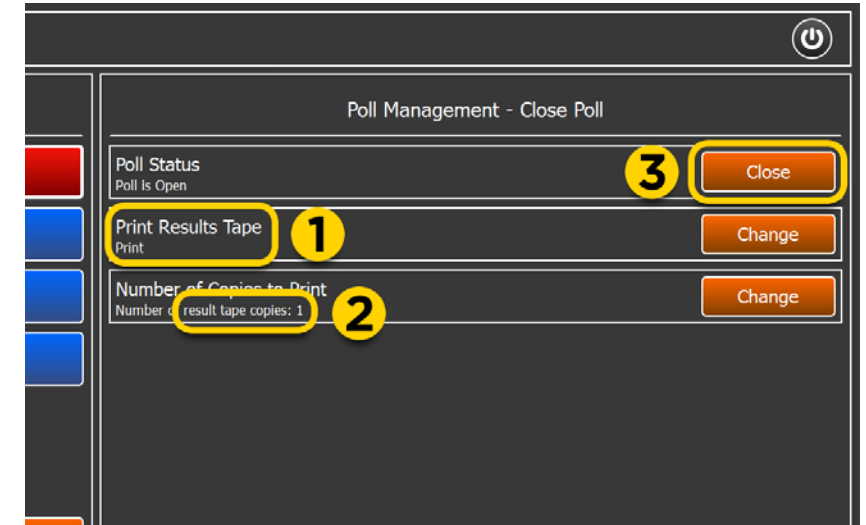

3 If a Results Tape is required, set the **Print Results Tape** option to **Print** (1). Select the desired **Number of Copies to Print** by pressing **Change** (2). Press **Close** (3) to continue.

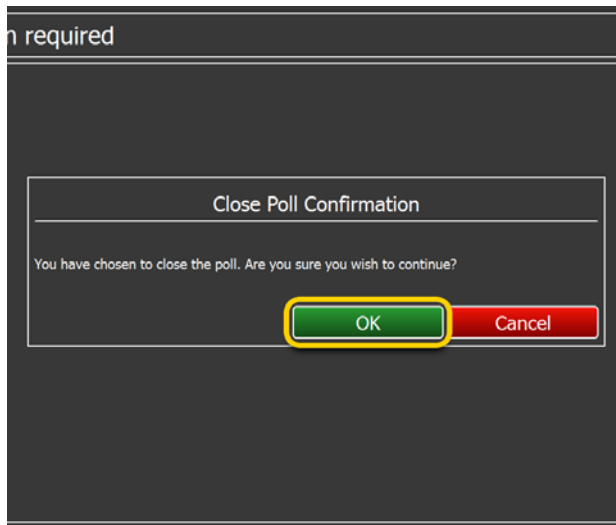

4 The **Close Poll Confirmation** screen appears. Press **OK** to continue or **Cancel** to return to the previous screen.



5 Verify that the auxiliary bin is empty. Press **OK** to confirm closing the poll.



6 If the **Print Results Tape** option was set to **Print**, the results tape begins printing.

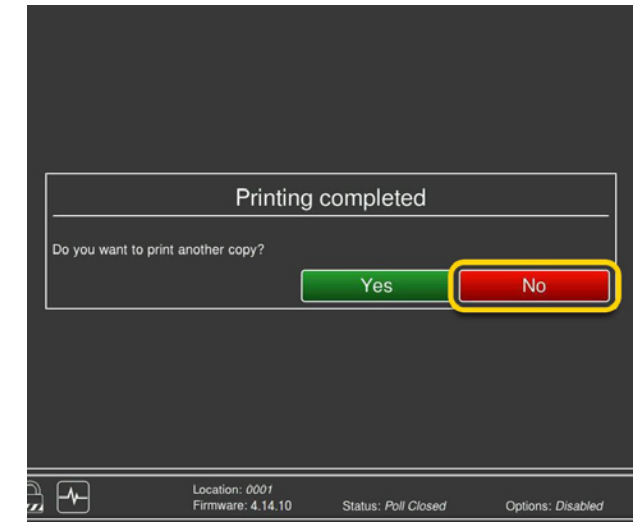

7 You will have the option to print another copy. If you are done printing, press **No**. Press **Yes** to print additional copies.

Powering Down The Unit



1 Press the power button at the top right hand corner of the screen.

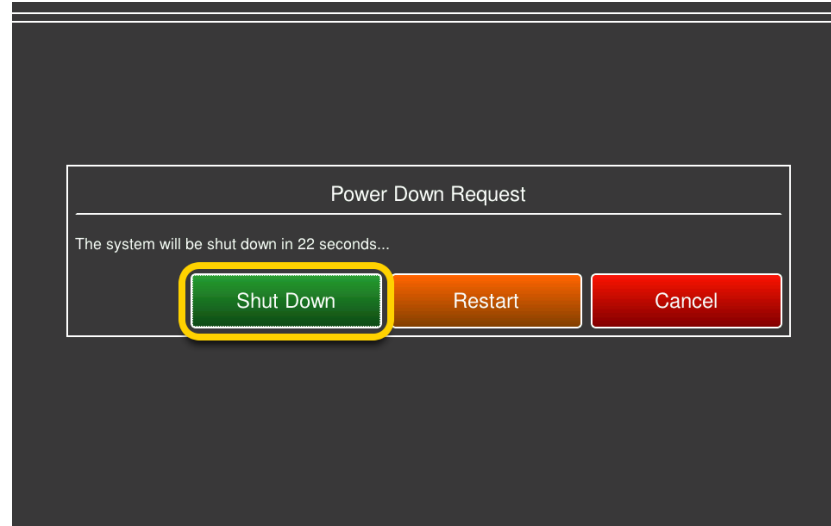

2 The **Power Down Request** screen appears. Press **Shut Down** to continue.

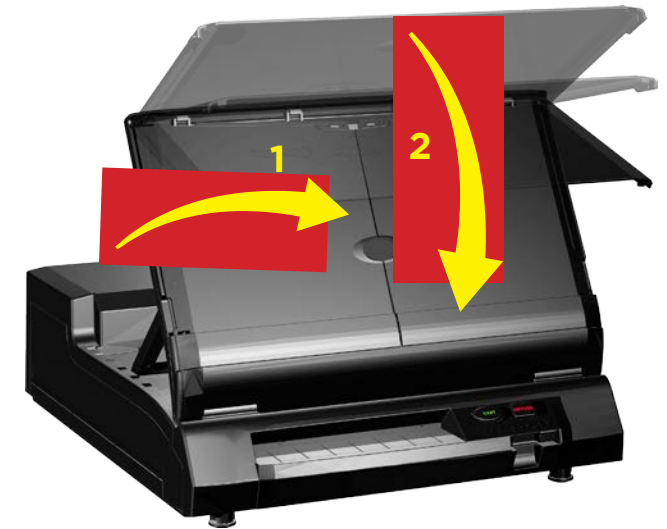

3 Close the left and right flaps to cover the screen. Then lower the top monitor cover.



4 Raise the monitor support stand.



5 Gently lower the monitor down onto the unit.



The ImageCast Evolution is now in storage position.

[PAGE INTENTIONALLY LEFT BLANK]

